

Bardac DC Drive Datasheet

Model: powerPL520/1150d

powerPL520/1150d | 1150A, 3-ph, 230V/460V, Non-Regen, Non-Reversing, DC Drive, includes: integrated input contactor, fusing, Ethernet and USB interface

Input Ratings

Supply Voltage	230V, 3-ph in 460V, 3-ph in
Input Current	1025 Amps

Output Ratings

Power at 240VDC	350 HP
Power at 500VDC	700 HP
Max Field Current	64 Amps
Max Armature Current	1150 Amps
Regen	No

Factory Build Options

Enclosure	Open Chassis
Frame Size	5
Dimensions (W x H x D)	20" x 29.8" x 13.8"
Weight	LBS

Miscellaneous

Feedback Types	Armature, Encoder, Tachometer
Max Watts Loss	3450 Watts

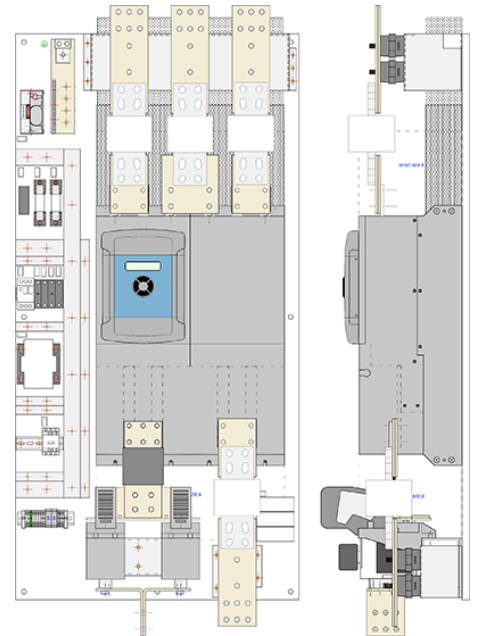

dw221 speedy (included in all suffix d PL/X drives)

Embedded controller with:

- Easy USB programming port
- Peer to peer Ethernet networking
- Programmable control functions

