

Bardac DC Drive Datasheet

Model: powerPL600/1350d

powerPL600/1350d | 1350A, 3-ph, 230V/460V, Non-Regen, Non-Reversing, DC Drive, includes: integrated input contactor, fusing, Ethernet and USB interface

Input Ratings

Supply Voltage	230V, 3-ph in 460V, 3-ph in
Input Current	1190 Amps

Output Ratings

Power at 240VDC	400 HP
Power at 500VDC	800 HP
Max Field Current	64 Amps
Max Armature Current	1350 Amps
Regen	No

Factory Build Options

Enclosure	Open Chassis
Frame Size	5
Dimensions (W x H x D)	30" x 67" x 16"

Miscellaneous

Feedback Types	Armature, Encoder, Tachometer
Max Watts Loss	4050 Watts

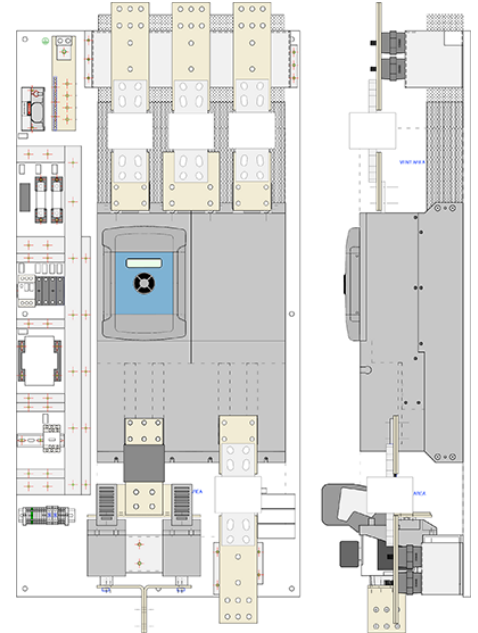

dw221 speedy (included in all suffix d PL/X drives)

Embedded controller with:

- Easy USB programming port
- Peer to peer Ethernet networking
- Programmable control functions

