

Bardac DC Drive Datasheet

Model: powerPL700/1650d

powerPL700/1650d | 1650A, 3-ph, 230V/460V, Non-Regen, Non-Reversing, DC Drive, includes: integrated input contactor, fusing, Ethernet and USB interface

Input Ratings

Supply Voltage	230V, 3-ph in 460V, 3-ph in
Input Current	1350 Amps

Output Ratings

Power at 240VDC	500 HP
Power at 500VDC	1000 HP
Max Field Current	64 Amps
Max Armature Current	1650 Amps
Regen	No

Factory Build Options

Enclosure	Open Chassis
Frame Size	5
Dimensions (W x H x D)	30" x 67" x 16"

Miscellaneous

Feedback Types	Armature, Encoder, Tachometer
Max Watts Loss	4950 Watts

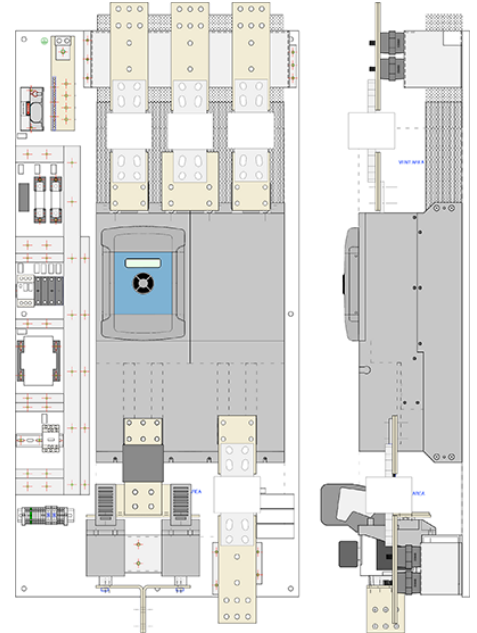

dw221 speedy (included in all suffix d PL/X drives)

Embedded controller with:

- Easy USB programming port
- Peer to peer Ethernet networking
- Programmable control functions

