

Bardac DC Drive Datasheet

Model: powerPL800/1750d

powerPL800/1750d | 1750A, 3-ph, 230V/460V, Non-Regen, Non-Reversing, DC Drive, includes: integrated input contactor, fusing, Ethernet and USB interface

Input Ratings

Supply Voltage	230V, 3-ph in 460V, 3-ph in
Input Current	1520 Amps

Output Ratings

Power at 240VDC	550 HP
Power at 500VDC	1100 HP
Max Field Current	64 Amps
Max Armature Current	1750 Amps
Regen	No

Factory Build Options

Enclosure	Open Chassis
Frame Size	5
Dimensions (W x H x D)	20" x 29.8" x 13.8"
Weight	LBS

Miscellaneous

Feedback Types	Armature, Encoder, Tachometer
Max Watts Loss	5250 Watts

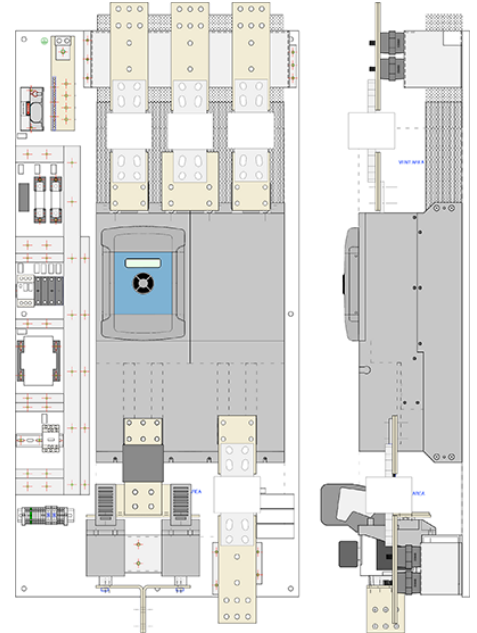

dw221 speedy (included in all suffix d PL/X drives)

Embedded controller with:

- Easy USB programming port
- Peer to peer Ethernet networking
- Programmable control functions

