

# Bardac DC Drive Datasheet

Model: powerPL900/1950d

**powerPL900/1950d | 1950A, 3-ph, 230V/460V, Non-Regen, Non-Reversing, DC Drive, includes: integrated input contactor, fusing, Ethernet and USB interface**

## Input Ratings

Supply Voltage	230V, 3-ph in   460V, 3-ph in
Input Current	1680 Amps

## Output Ratings

Power at 240VDC	600 HP
Power at 500VDC	1200 HP
Max Field Current	64 Amps
Max Armature Current	1950 Amps
Regen	No

## Factory Build Options

Enclosure	Open Chassis
Frame Size	5
Dimensions (W x H x D)	20" x 29.8" x 13.8"
Weight	LBS

## Miscellaneous

Feedback Types	Armature, Encoder, Tachometer
Max Watts Loss	5850 Watts

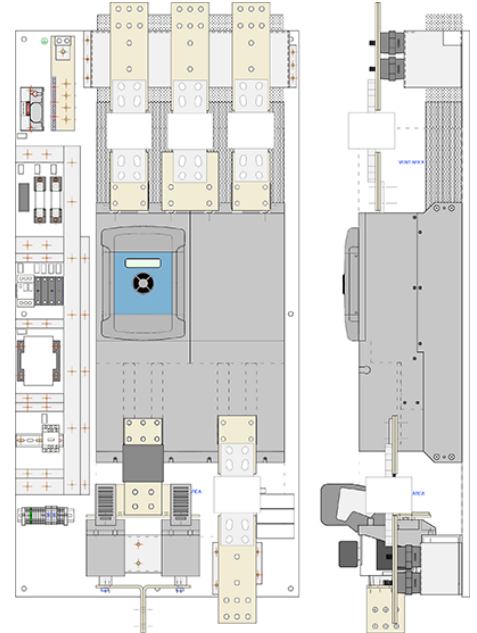

**dw221 speedy** (included in all suffix d PL/X drives)

Embedded controller with:

- Easy USB programming port
- Peer to peer Ethernet networking
- Programmable control functions

