

# Bardac DC Drive Datasheet

Model: powerPLX600/1350d

**powerPLX600/1350d | 1350A, 3-ph, 230V/460V, Regen, Reversing, DC Drive, includes: integrated input contactor, fusing, Ethernet and USB interface**

## Input Ratings

Supply Voltage	230V, 3-ph in   460V, 3-ph in
Input Current	1190 Amps

## Output Ratings

Power at 240VDC	400 HP
Power at 500VDC	800 HP
Max Field Current	64 Amps
Max Armature Current	1350 Amps
Regen	Yes

## Factory Build Options

Enclosure	Open Chassis
Frame Size	5
Dimensions (W x H x D)	30" x 67" x 16"

## Miscellaneous

Feedback Types	Armature, Encoder, Tachometer
Max Watts Loss	4050 Watts

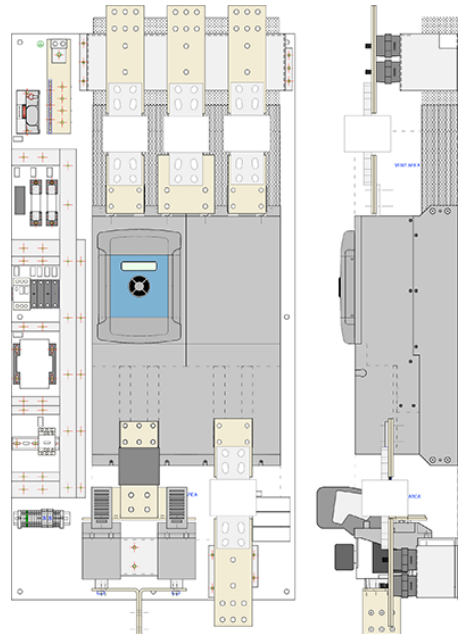

**dw221 speedy** (included in all suffix d PL/X drives)

Embedded controller with:

- Easy USB programming port
- Peer to peer Ethernet networking
- Programmable control functions

