

Bardac DC Drive Datasheet

Model: powerPLX800/1750d

powerPLX800/1750d | 1750A, 3-ph, 230V/460V, Regen, Reversing, DC Drive, includes: integrated input contactor, fusing, Ethernet and USB interface

Input Ratings

| | |
|----------------|-------------------------------|
| Supply Voltage | 230V, 3-ph in 460V, 3-ph in |
| Input Current | 1520 Amps |

Output Ratings

| | |
|----------------------|-----------|
| Power at 240VDC | 550 HP |
| Power at 500VDC | 1100 HP |
| Max Field Current | 64 Amps |
| Max Armature Current | 1750 Amps |
| Regen | Yes |

Factory Build Options

| | |
|------------------------|-----------------|
| Enclosure | Open Chassis |
| Frame Size | 5 |
| Dimensions (W x H x D) | 30" x 67" x 16" |
| Weight | LBS |

Miscellaneous

| | |
|----------------|-------------------------------|
| Feedback Types | Armature, Encoder, Tachometer |
| Max Watts Loss | 5250 Watts |

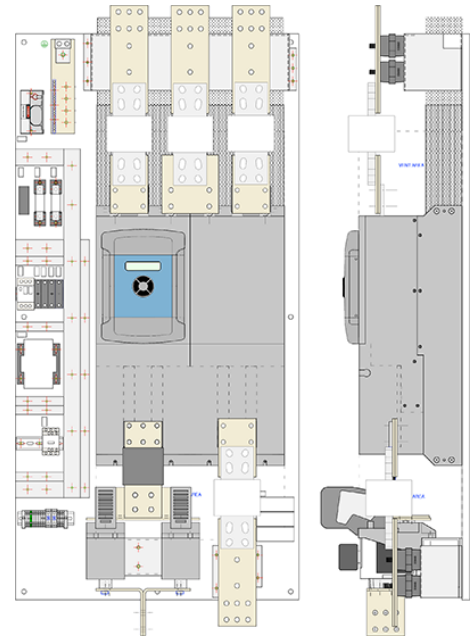

dw221 speedy (included in all suffix d PL/X drives)

Embedded controller with:

- Easy USB programming port
- Peer to peer Ethernet networking
- Programmable control functions

