

## OPTIDRIVE EI Single Phase Output

Enclosed IP55 / NEMA 12

AC Variable Speed Drive 0.37 – 1.1kW / 0.5 – 1.5HP



Installation and operating instructions

### User Guide

All rights reserved. No part of this User Guide may be reproduced or transmitted in any form or by any means, electrical or mechanical including photocopying, recording or by any information storage or retrieval system without permission in writing from the publisher.

Copyright Invertek Drives Ltd © 2006

The manufacturer accepts no liability for any consequences resulting from inappropriate, negligent or incorrect installation, or adjustment of the optional operating parameters of the drive or from mismatching of the drive to the motor.

The contents of this User Guide are believed to be correct at the time of printing. In the interests of a commitment to a policy of continuous improvement, the manufacturer reserves the right to change the specification of the product or its performance or the contents of the User Guide without notice.

#### SAFETY

This variable speed drive product (Optidrive) is intended for professional incorporation into complete equipment or systems. If installed incorrectly it may present a safety hazard. The Optidrive uses high voltages and currents, carries a high level of stored electrical energy, and is used to control mechanical plant that may cause injury. Close attention is required to system design and electrical installation to avoid hazards in either normal operation or in the event of equipment malfunction.

System design, installation, commissioning and maintenance must be carried out only by personnel who have the necessary training and experience. They must read carefully this safety information and the instructions in this Guide and follow all information regarding transport, storage, installation and use of the Optidrive, including the specified environmental limitations. **Please read the IMPORTANT SAFETY INFORMATION below, and all Warning and Caution boxes elsewhere.**

#### SAFETY NOTICES

**WARNING** is given where there is a hazard that could lead to injury or death of personnel

**CAUTION** is given where there is a hazard that could lead to damage to equipment



82-55E1P-BA

#### Bardac Corporation

[www.bardac.com](http://www.bardac.com)

40 Log Canoe Circle, Stevensville, MD 21666 USA

USA Toll Free Phone: 1-888-667-7333 (1-888-ON SPEED)

International Phone: 410-604-3400 Fax: 410-604-3500

Made in the UK by Invertek Drives Ltd Iss3.01

#### SAFETY NOTICES

It is the responsibility of the installer to ensure that the equipment or system into which the product is incorporated complies with the EMC legislation of the country of use. Within the European Union, equipment into which this product is incorporated must comply with 89/336/EEC, Electromagnetic Compatibility.

**WARNING** The level of integrity offered by the Optidrive control functions – for example stop/start, forward/reverse and maximum speed, is not sufficient for use in safety-critical applications without independent channels of protection. All applications where malfunction could cause injury or loss of life must be subject to a risk assessment and further protection provided where needed. Within the European Union, all machinery in which this product is used must comply with Directive 89/392/EEC, Safety of Machinery. In particular, the electrical equipment should comply with EN60204-1.

#### WARRANTY

All Invertek Drives Ltd (IDL) products carry a 2-year warranty, valid from the date of manufacture. Complete Warranty Terms and Conditions are available upon request from your IDL Authorised Distributor.

#### CAUTION

- Carefully inspect the Optidrive before installation to ensure it is undamaged
- Store the Optidrive in its box until required. Storage should be clean and dry Temp. Range -40°C to +60°C
- Install the Optidrive on a flat, vertical, flame-resistant vibration-free mounting according to EN60529 if specific Ingress Protection ratings are required.
- Indoor Use Only.
- Flammable material should not be placed close to the drive
- The entry of conductive or flammable foreign bodies should be prevented
- Max. ambient temperature 40°C, min. -5°C. Refer to table on reverse side.
- Relative humidity must be less than 95% (non-condensing).
- The Optidrive is suitable for use on a circuit capable of delivering not more than 5KA (50Hp) / 10KA (51-200HP) symmetrical amperes, 480V maximum.

#### Lock Off:

On the switched models the main power isolator switch can be locked in the 'Off' position using a 20mm standard shackle padlock (not supplied).

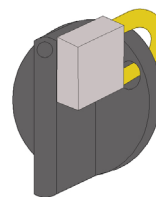

#### WARNING

- Optidrives should be installed only by qualified electrical persons and in accordance with local and national regulations and codes of practice. The Optidrive has an Ingress Protection rating of IP55. For higher IP ratings, use a suitable enclosure.
- **Electric shock hazard!** Disconnect and ISOLATE the Optidrive before attempting any work on it. High voltages are present at the terminals and within the drive for up to 10 minutes after disconnection of the electrical supply
- Where supply to the drive is through a plug and socket connector, do not disconnect until 10 minutes have elapsed after turning off the supply
- Ensure correct earthing connections
- The earth cable must be sufficient to carry the maximum supply fault current which normally will be limited by the fuses or MCB

#### WARNING

- The STOP function does not remove potentially lethal high voltages. ISOLATE the drive and wait 10 minutes before starting any work on it
- Parameter P-01 can be set to operate the motor at up to 3,000 rpm, hence use this parameter with care
- If it is desired to operate the drive at any frequency/speed above the rated speed (P-09/ P-10) of the motor, consult the manufacturers of the motor and the driven machine about suitability for over-speed operation
- The fan (if fitted) to the heatsink of the Optidrive starts automatically when the heatsink temperature reaches approximately 40°C. When the heatsink is at room temperature the fan will be stopped.

#### CAUTION

- Ensure that the supply voltage, frequency and no. of phases (1 or 3 phase) correspond to the rating of the Optidrive as delivered.
- An isolator should be installed between the power supply and the drive.
- Never connect the mains power supply to the Output terminals U & V.
- Protect the drive by using slow-blowing HRC fuses or MCB located in the mains supply of the drive
- Do not install any type of automatic switchgear between the drive and the motor
- Wherever control cabling is close to power cabling, maintain a minimum separation of 100 mm and arrange crossings at 90°
- Ensure that screening or armouring of power cables is effected in accordance with the connections diagram below
- Ensure that all terminals are tightened to the appropriate torque (see table)

#### IMPORTANT SAFETY INFORMATION

Safety of machinery, and safety-critical applications

Optidrive hardware and software are designed and tested to a high standard and failures are unlikely.

Electromagnetic Compatibility (EMC)

Optidrive is designed to high standards of EMC. EMC data is provided in a separate EMC Data Sheet, available on request. Under extreme conditions, the product might cause or suffer disturbance due to electromagnetic interaction with other equipment. It is the responsibility of the installer to ensure that the equipment or system into which the product is incorporated complies with the EMC legislation of the country of use. Within the European Union, equipment into which this product is incorporated must comply with 89/336/EEC, Electromagnetic Compatibility.

When installed as recommended in this User Guide, the radiated emissions levels of all Optidrives are less than those defined in the Generic radiated emissions standard EN61000-6-4. When fitted with an optional internal filter, the conducted emission levels are less than those defined in the Generic radiated emissions standard EN61000-6-3 (class B) for screened cable lengths of < 1m and with EN61000-6-4 (class A) for screened cable lengths of < 5m.

#### STANDARDS CONFORMITY

The Optidrive E I55 conforms with the following standards

- 1) CE marked for low voltage directive
- 2) IEC 664-1 Insulation coordination for equipment within low voltage systems
- 3) EN61800-3 Adjustable Speed electrical power drive systems – Part 3 (EMC)
- 4) EN 61000-6 / -2, -3, -4 Generic Immunity / Emissions standards (EMC)
- 5) UL508C Power conversion equipment

### CONNECTION DIAGRAM

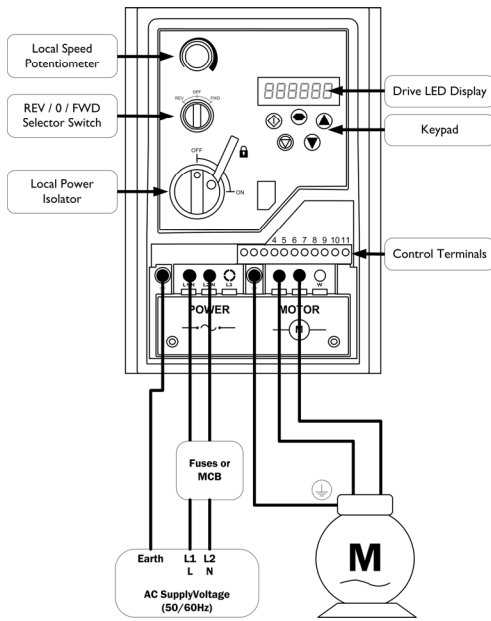

NOTE: the REV switch setting has no effect

### ELECTRICAL INSTALLATION

Connect drive according to diagram (above), ensuring that motor terminal box connections are correct (see diagram, below).

Refer to the **ELECTRICAL DATA** overleaf for the sizes of cabling and wiring. It is recommended that the power cabling should be 3-core or 4-core PVC-insulated screened cable, laid in accordance with local industrial regulations and codes of practice.

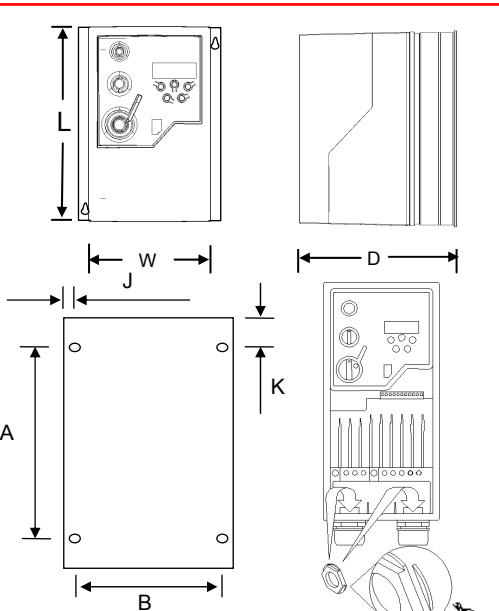

### MECHANICAL INSTALLATION

Carefully inspect the IP55 Optidrive before installation to ensure it is undamaged.

Store the IP55 Optidrive in its box until required. Storage should be clean and dry and within the temperature range -40°C to 60°C. Install the IP55 Optidrive on a flat, vertical, flame-resistant, vibration-free mounting (**NOTE: Drive is for INDOOR USE ONLY**). Flammable material should not be placed close to the drive. The entry of conductive or flammable foreign bodies should be prevented.

Max. Operational ambient temperature 40°C, min. 0°C. Relative humidity must be less than 95% (non-condensing). IP55 Optidrives can be installed side-by-side with their heatsink flanges touching. This gives adequate ventilation space between them. If the IP55 Optidrive is to be installed above another drive or any other heat-producing device, the minimum vertical spacing is 150mm.

Some types of gland nut will require modification for correct installation. Remove one or more flanges as shown until the nut will fit in the apertures.

Any Metal conduit used **MUST** be earth bonded by means of suitable earthing washer or gland adaptor.

### OPERATION – USING THE KEYPAD MANAGING THE KEYPAD

When the drive is delivered from the factory, only the Standard Parameter Set (see overleaf) is accessible.

To access the Standard Parameter Set, press the Navigate key ⇄ for >1 sec.

- Scroll through P-01 to P-14 (and roll over to P-01) by pressing ▲ or ▼
- To display the parameter value, press ⇄
- To edit the parameter value, press ▲ or ▼
- To return to the parameter number, press ⇄
- To store a value and / or exit from edit mode, press ⇄ for >1 sec or press no button for >20 sec.

To access the Extended Parameter Set, set P-14 = 101 and press ⇄

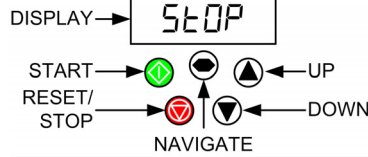

NOTE To restrict unauthorised access, make P-37 = any value from 0 to 9999.

- When in the Extended Parameter Set (except P-00), the display will revert to normal if no button is pressed for >20 sec.

### TO RESTORE ALL DEFAULT VALUES,

stop the drive and when display shows StoP, press and hold the ▲, ▼ and STOP keys simultaneously for 1 second. The display will show P-dEF. Access code P-37 will revert to 101 but the hours-run meter P-39 is not affected. Press STOP to resume normal operation.

### CONTROL TERMINAL BLOCK - Default Status

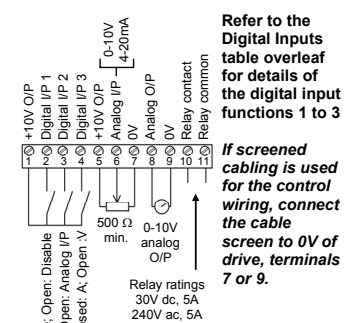

Refer to the Digital Inputs table overleaf for details of the digital input functions 1 to 3

Relay ratings  
30V dc, 5A  
240V ac, 5A

### OPERATING IN KEYPAD MODE

Set P-12 = 1 (this allows the Optidrive to be controlled from the keypad):

- Enable the drive by closing digital input 1. The display will show StoP.
- Press the START key. The display shows H 0.0.
- Press ▲ to increase speed
- The drive will run forward, increasing speed until ▲ is released.
- **CAUTION:** the rate of acceleration is controlled by the setting of P-03, check this before starting.
- Either Press ▼ to decrease speed
- The drive will decrease speed until ▼ is released. The rate of deceleration is limited by the setting in P-04
- Or Press the STOP key. The drive will decelerate to rest at the rate set in P-04.
- The display will finally show StoP at which point the drive is disabled
- To preset a target speed prior to enable press the stop key whilst the drive is stopped. The display will show the target speed, use the ▲ and ▼ to adjust as required then press the Stop key to return the display to StoP. Pressing the START key will start the drive accelerating to the target speed.

The operation of the keypad can be duplicated using remote pushbuttons connected to the control terminals, see Application Note AN21. In this mode, if P30 is set to Auto-0..4, then the drive will run as soon as the drive enable is applied (terminal 1 & 2 is closed).

TO SAVE CHANGES to Parameter settings, switch the power supply off and wait for the drive to power down (screen blank) before switching on.

NOTE that this assumes P-38 = 0 (default). If P-38 = 1, changes are not saved.

### OPERATION – BASICS + GETTING STARTED PSC MOTOR WIRING

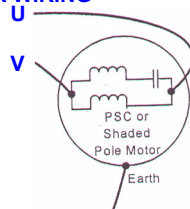

### DIMENSIONS - NOTE: INDOOR USE ONLY

#### IP55 ODE DIMENSIONS & TORQUE SETTINGS (inc. Feet)

	Size 1	Size 2
Length / mm	200	310
Width / mm	140	165
Depth / mm	162	176
Weight/ kg	2.3	4.5
A / mm	142	252
B / mm	128	153
J / mm	6.0	6.0
K / mm	25.0	25.0
Fixings	2 * M4	4 * M4
Power terminal torque settings	1 Nm	1 Nm
Control terminal torque settings	0.5Nm	0.5Nm

#### Gland Hole Sizes:

	I/P & O/P Power (Φ)	Centred Knockout (Φ)	Terminal Cover Knockout (Φ)
Size 1	(22mm)	(22mm)	(17mm)
Size 2	(25mm)	(22mm)	(17mm)

#### Recommended Gland Type:

SkinTop UL approved (UL94-V0) Type12/IP55 non-metallic cable gland or non-rigid conduit

	I/P & O/P Power	Centred Knockout	Terminal Cover Knockout
Size 1	PG13.5 / M20	PG13.5 / M20	PG9/ M16
Size 2	PG16 / M25	PG13.5 / M20	PG9/ M16

#### GROUNDING (EARTHING)

The ground terminal of each Optidrive should be individually connected DIRECTLY to the site earth (ground) busbar (through the filter if installed) as shown. Optidrive ground connections should not loop from one drive to another, or to, or from any other equipment. Ground loop impedance must conform to local industrial safety regulations. To meet UL regulations, UL approved ring crimp terminals should be used for all earth wiring connections.

### EASY STARTUP

When delivered, the Optidrive is in the default state, meaning that it is set to operate in terminal mode and all parameters (P-xx) have the default values as shown overleaf.

- Connect a control switch between the control terminals 1 and 2 (FWD position).
- Connect a potentiometer (500 Ω min to 10 kΩ max) between terminals 5 and 7, and wiper to terminal 6 (Local Speed Potentiometer).
- Set the control switch between pins 1 and 2 open so that the drive is 'disabled' (0).
- With the potentiometer set to zero, switch on the supply to the drive. The display will show StoP.
- Close the control switch, terminals 1-2 (FWD). The drive is now 'enabled' and the output frequency/speed are controlled by the potentiometer. The display shows zero speed in Hz (H 0.0) with the potentiometer turned to minimum.
- Turn the potentiometer to maximum. The motor will accelerate to 50Hz (the default value of P-01) under the control of the accelerating ramp time P-03. The display shows H 50.0 (50Hz) at max speed.
- To display motor current (A), briefly press the Navigate key ⇄.
- Press ⇄ again to return to speed display.
- To stop the motor, either turn the potentiometer back to zero or disable the drive by opening the control switch (terminals 1-2) (0).

If the enable/disable switch is opened the drive will decelerate to stop at which time the display will show StoP. If the potentiometer is turned to zero and the enable/disable is closed the display will show 0.0Hz, if left like this for 20 seconds the drive will go into standby mode, display shows Stndby, waiting for a speed reference.

Values in ( ) are for the settings on the switched variants

### PARAMETER ZERO

- Provides a read only window into the motor control software allowing key internal values to be viewed. This is useful for following signals through the drive control system when troubleshooting.
- Access, scroll, change and exit are as for any other parameter. The selected variable is at the left hand side of the display.
- There are 9 different windows listed below:
  - 1 Unscaled analog input (%)
  - 2 Speed ref. via scaled analog input (Hz)
  - 3 Pre-ramp speed ref. (Hz)
  - 4 Post-ramp speed ref. (Hz)
  - 5 Not used
  - 6 Stator field frequency (Hz)
  - 7 Applied motor voltage (V)
  - 8 DC bus voltage (V)
  - 9 Internal thermistor (NTC) value

**STANDARD PARAMETER SET**

Par.	Description	Range	Default	Explanations	Set to
P-01	Maximum speed	P-02 to 5*P-09 (max 500Hz)	50Hz	Maximum speed limit – Hz or rpm. See P-10	
P-02	Minimum speed	0 to P-01 (max 500Hz)	10Hz	Minimum speed limit – Hz or rpm. See P-10	
P-03	Accel ramp time (s)	0 to 3,000s	5s	Acceleration ramp time from 0 to base speed (P-9) in seconds	
P-04	Decel ramp time (s)	0 to 3,000s	5s	Deceleration ramp time from base speed (P-9) to 0 in seconds	
P-05	Stop mode select	0, 2: Ramp stop 1: Coast to stop	0	If the supply is lost and P-05=0 then the drive will try to continue running by reducing the speed of the load using the load as a generator. If P-05=2, the drive ramps at P-07 to stop.	
P-06	V/F characteristic	0: Constant torque, <b>INDUSTRIAL</b> 1..10: Pump/fan, <b>HVAC</b>	0	Either V = kf (linear) or V = kf <sup>2</sup> (pumps / fans with HVAC rating). Note when P-06 is set to 1 the ramps are automatically set to 60 s.	
P-07	Fast stop (s)	0.0 to 25s. (Disabled when 0.0s)	0.0s	Deceleration ramp time after mains loss (P-05 = 0 or 2) or when fast stop activated (see P-19). When P-05 = 2 and P-07 = 0, activating the fast stop disables the drive without braking (effectively coasting to stop).	
P-08	Motor rated current	25% -100% of drive current rating	Drive rating	Rated (nameplate) current of the motor (Amps). In HVAC (P-06 = 1) mode, the rated motor current limit is increased, allowing P-08 to be set to a higher level	
P-09	Motor rated frequency	25Hz to 500Hz	50 Hz (60Hz - HP)	Rated (nameplate) frequency of the motor. Changing P-09 resets P-02, P-10, P-26 & P-28 to 0, & P-01=P-09.	
P-10	Motor rated speed	0, P-09*12 to P-09*60 eg for 50Hz motor, range is 600 to 3000 rpm	0	When non-zero, speed is displayed in rpm in parameters P-01, P-02, P-20...P-23, P-27 and P-28	
P-11	Voltage boost	0 to 25% of max output voltage	3%	Applies an adjustable boost to the Optidrive voltage output at low speed to assist with starting 'sticky' loads. For continuous applications at low speed use a forced ventilated motor.	
P-12	Terminal or Keypad control	0: Terminal control 1: Keypad control – fwd only 2: Keypad control – fwd and rev 3: Terminal control 4: Not used	0 (Terminal control)	When P-12 = 2, the keypad START key toggles between forward and reverse. When stopped, target speed can be accessed / changed using the STOP & ▲, ▼ buttons.  3: Terminal control	
P-13	Trip log	Last four trips stored	Read only	Most recent 4 trips stored in order of occurrence, ie on entry, display shows most recent first. Press ▲ or ▼ to step through all four	
P-14	Extended menu access	Code 0 to 9999	0	Set to "101" (default) for extended menu access. Change code in P-37 to prevent unauthorised access to the Extended Parameter Set	

**EXTENDED PARAMETER SET**

Par.	Description	Range	Default	Explanations	Set to
P-15	Motor rated voltage	115V product: 40V to 150V 230V product: 40V to 250V	115V for 115V 230V for 230V	When P-15 is non-zero, the applied motor voltage is controlled and scaled so that the specified voltage is achieved at rated freq (P-09)	
P-16	Analog input format (V / mA)	Voltage: 0-10V, 10-0V Current: 4-20mA, 0-20mA, 20-4mA	0-10V	Analog input format (on terminal 6).	
P-17	Switching frequency	8, 16, 32 kHz	16 kHz	Effective power stage switching frequency. Improvements in acoustic noise and output current waveform occur with increasing switching frequency at the expense of increased losses within the drive	
P-18	Relay output function	0: Drive enabled 1: Drive healthy (not tripped) 2: Motor at set speed 3: Motor speed > zero 4: Motor at max speed (P-01) 5: Motor current overload	1	Relay output function. Contacts closed if selected condition is true. When P-18=3, (zero speed), the relay contacts close when the output frequency is greater than 5% of base frequency. The drive is in overload when the motor current exceeds P-08	
P-19	Digital inputs function select	0 to 5, See digital input table	0	Defines function of digital inputs (see also P-16 and Digital Inputs table)	
P-20	Preset speed 1	-P-02 (min) to P-01 (max)	50hz/rpm	Defines Speed Preset1	
P-21	Preset speed 2	-P-02 (min) to P-01 (max)	0 Hz/rpm	Defines Speed Preset 2	
P-22	Preset speed 3	-P-02 (min) to P-01 (max)	0 Hz/rpm	Defines Speed Preset 3	
P-23	Preset speed 4	-P-02 (min) to P-01 (max)	0 Hz/rpm	Defines Speed Preset 4	
P-24	Reserved				
P-25	Analog output function	(A) 0:Motor Speed 1:Motor current (D) 2:Drive enabled 3: Set speed	0	Analog output select. When P-25 = 0 then 10V = 100% of P-01, or if P-25 =1 then 10V = 200% of P-08. P-25 = 2 or 3 gives a 10V digital output.	
P-26	Reserved				
P-27	Skip freq / speed	P-02 (min) to P-01 (max)	0 (inactive)	Centre point for skip frequency band. The skip frequency band defined by P-27, P-28 is mirrored around zero for negative speeds.	
P-28	Skip freq / speed band	0 to 100% of rated speed/freq. P-09	0 Hz / rpm	Width of skip frequency band, the center of which is defined by P-27.	
P-29	Reserved				
P-30	Drive start mode	Edge-r: Close Digital input 1 after power up to start drive Auto-0: drive runs whenever Digital input 1 closed. Auto-1..4: as Auto-0, except 1..4 Attempts to restart after a trip	Auto-0	When set to Edge-r, if drive is powered up with Digital Input 1 closed (enabled), drive will not run. The switch must be opened & closed after power up or after a clearing a trip for the drive to run. When set to Auto-0, drive will run whenever digital input 1 is closed (if not tripped). Auto-1..4 makes 1..4 attempts to automatically restart after a trip (25s between attempts). If fault has cleared drive will restart. Drive must be powered down, reset on the keypad or reset by re-enabling the drive to reset auto-reset counter. When P-12 is set to 1 or 2, P-30 changes automatically to Edge-r.	
P-31	Boost frequency	0 to 250Hz	50Hz	Optidrive1ph start up frequency maintained during the startup boost period	
P-32	Boost duration	0 to 25s	2s	Time for which the startup boost period is maintained	
P-33	Boost start voltage	0 to 100%	20%	% of operational motor voltage applied at start of startup boost period. The applied voltage is increased to the operational voltage at end of startup boost period.	
P-34	Reserved				
P-35	Analog input scaling factor	25% to 500%	80% at 50Hz, 84% at 60Hz	Scales the analog input at control terminal 6 up or down, or the digital reference in keypad (or Slave) mode up or down (see P-12).	
P-36	Drive address (s-comms)	0 to 63 (0=disable)	1	Distinct drive address for serial comms. 0 = comms disabled	
P-37	Access code definition	0 to 9999	101	Defines Extended Parameter Set access code, P-14	
P-38	Parameter access lock	0: Parameters can be changed, auto-saved on power down 1: Parameter changes not saved on power down 2: Read-only. No changes allowed.	0 (write access and auto-save are enabled)	Controls user access to parameters. When P-38 = 0, all parameters can be changed and these changes will be stored automatically. When P-38 = 1, changes may be made but these will not be stored when the Optidrive1ph powers down. When P-38 = 2, parameters are locked and cannot be changed thus preventing unauthorised access.	
P-39	Hours run meter	0 to 99999 hours	Read only	Not affected by reset-to-default command	
P-40	Software checksum	0000 to FFFF (hex)	Read only	Drive rating, drive type and software version codes	

**IP55 OPTIDRIVE E1/EF1 SIZE 1 - 115V (-I55 Unswitched, -I55S Switched)**

Model	ODE1-xxxxx-USA-I55/I55S	11050
Supply voltage	+/- 10%	110-115
Phases		1
Motor output rating	KW HP	0.37 0.5
Output Amps	A	7.0
Fuse or Circuit Breaker rating	A	10
Max ambient temperature	°C 8kHz °C 16kHz °C 32kHz	40 30
Motor cable size, Cu 75C	AWG	14
Max motor cable length	m/ ft	50 / 160'

**IP55 OPTIDRIVE E1/EF1 SIZE 1 - 230V (-I55 Unswitched, -I55S Switched)**

Model	ODE1-xxxxx-IN/USA-I55/I55S	12037 / 12050	12075 / 12100
Supply voltage	+/- 10%	220-240	
Phases		1	
Motor output rating	kW Hp	0.37 0.5	0.75 1
Output Amps	A	4.3	7
Fuse or Circuit Breaker rating	A	10	20
Max ambient temperature	°C 8kHz °C 16kHz °C 32kHz	40 30	40 30
Motor cable size, Cu 75C	AWG	16	14
Max motor cable length	m/ ft	50 / 160'	

**IP55 OPTIDRIVE E1/EF1 SIZE 2 - 110V/240V (-I55 Unswitched, -I55S Switched)**

Model	ODE1-xxxxx-IN/USA-I55/I55S	21075	22110 / 22150
Supply voltage	+/- 10%	110-115	220-240
Phases		1	
Motor output rating	HP kW	3/4 0.55	1.5 1.1
Output current	A	10.5	10.5
Fuse or circuit breaker rating	A	20	20
Max ambient temperature	°C 8kHz °C 16kHz °C 32kHz	40 30	40 30
Motor cable size, Cu 75C	AWG	14	14
Max motor cable length	m/ft	100 / 320'	100 / 320'

**DIGITAL INPUTS – TERMINAL MODE (P-12 = 0, 3 or 4)**

P-19	Input 1 function	Input 2 function	Input 3 function	Additional Information
0	Open: Stop (disable) Closed: Run (enable)	Open: Analog input Closed: Speed Preset 1	Volts / Current analog input	The format of the current analog input is defined by P-16, if P-16 is set to 0-10V a 4-20mA format will be assumed when input 3 closed
1	Open: Stop (disable) Closed: Run (enable)	Open: Analog input Closed: Speed Preset 1/2, (Digital Input 3 selects)	Open: Speed Preset 1 Closed: Speed Preset 2	
2	Open: Stop (disable) Closed: Run (enable)	Digital Input 2: Open \ Digital Input 3: Open / Digital Input 3: Open \ Digital Input 2: Closed / Digital Input 3: Closed \ Digital Input 2: Open / Digital Input 3: Closed \ Digital Input 2: Open / Digital Input 3: Closed \ Digital Input 2: Open / Digital Input 3: Closed /	▶ Selects Speed Preset 1 ▶ Selects Speed Preset 2 ▶ Selects Speed Preset 3 ▶ Selects Speed Preset 4	
3	Open: Stop (disable) Closed: Run (enable)	External trip input: Open: TRIP; Closed: OK	Open: Analog Input Closed: Speed Preset 1	
4	Normally Open (N.O.) Momentarily Close to run	Normally Closed (N.C.) Momentarily Open to stop	Open: Analog Input Closed: Speed Preset 1	
5	Open: Stop (disable) Closed: Run (enable)	Close to run Open to fast stop (P-07)	Open: Analog Input Closed: Speed Preset1	Wire break mode. Fast stop (P-07) activated when input 1 & input 2 closed at same time.

**OPTIDRIVE - E OPTIONS**  
The following additional products are available:

- Internal and external EMC filters to meet EN 61000-6-3 / -4 for conducted emissions
- Dual relay output and dual analog input, 2ROUT& 2ANIN
- Feedback control card, PICON

**GENERAL TECHNICAL DATA**

- Supply frequency 48 to 62 Hz.
- Max. permissible 3-phase supply imbalance 3%.
- Max. ambient temperature 40 °C.
- Max. altitude 2000 m.
- Derate above 1000 m, 1% / 100 m.
- Derate output current 5%/ °C above max. ambient temp up to 55°C
- 1 x t protection above 100% output current.
- 150% overload protection for 60 sec.
- 175% overload allowable for 2 sec.
- Storage temperature - 40 to +60 °C

**FURTHER INFORMATION**  
[www.invertek.co.uk](http://www.invertek.co.uk), contains the following:

- General information, including Product and Options Manuals
- Company and IDL authorised dealer information

**DIGITAL INPUTS – KEYPAD MODE (P-12 = 1 or 2)**

P-19	Input 1 function	Input 2 function	Input 3 function	Additional Information
0,1,2,4,5	Open: Stop (disable) Closed: Run (enable)	Closed: remote up pushbutton	Closed: remote down pushbutton	Closing inputs 2 & 3 at same time starts the drive.
3	Open: Stop (disable) Closed: Run (enable)	External trip input: Open: TRIP; Closed: no trip	Open: Keypad speed reference Closed: Preset / Jog Speed 1	Speed reference is set by pushbuttons.

**TROUBLESHOOTING**

**TO CLEAR A TRIP CONDITION** Remove the condition which caused the trip and press the STOP key or re-enable the drive. The drive will restart according to the mode selected by P-30. If the motor is stopped and the display shows STOP, there is no fault; the drive output is disabled and the drive is ready to run.

Fault Code	What has happened	What to do
P-deF	Default parameters loaded	Press STOP key, drive is ready to configure for particular application
O-I	Over current on drive output. Excess load on the motor. Over temperature on the heatsink	Motor at constant speed: investigate overload or malfunction. Motor starting: load stalled or jammed. Check for star-delta motor wiring error. Motor accelerating/decelerating: The accel/decel time too short requiring too much power. If P-03 or P-04 cannot be increased, a bigger drive is needed
O-Uolt	Over voltage on DC bus	Supply problem, or increase decel ramp time P-04.
U-Uolt	Under voltage on DC bus	This occurs routinely when power is switched off. If it occurs during running, check power supply voltage.
I.t-trP	The drive has tripped on overload after delivering greater than 100% load for a period of time.	Check to see when the decimal points are flashing (drive in overload) and either decrease acceleration rate or load. Check cable length is within specification.
th-Flt	Faulty thermistor on heatsink.	Refer to your IDL Authorised Distributor.
E-triP	External trip (on dig. input 2 or 3)	External trip on digital input – see P-19 (motor thermistor?)
EE-F	EEPROM fault. Parameters not saved, defaults reloaded.	Try again. If problem recurs, refer to your IDL Authorised Distributor.
PS-Trp	Internal power stage fault	Check wiring to motor, look for ph-ph or ph-Earth short circuit. Check drive ambient temp, additional space or cooling needed? Check drive is not forced into overload.
O-t	Heatsink over temperature	Check drive ambient temp. Additional space or cooling needed?
Iin-F	Current analog input out of range	Check input current in range defined by P-16

**SIMPLE PARAMETER ADJUSTMENTS**

The factory-set default parameter values may give satisfactory performance, however certain adjustments may be beneficial.

**Maximum and Minimum Speeds P-01 & P-02**  
Set P-01 to the maximum speed and P-02 to the minimum speed for your application. These limits are mirrored for negative speeds. If a non-zero minimum speed is set in P-02, the motor will ramp (P-03) to this minimum speed as soon as the drive is enabled.

**Acceleration and Deceleration P-03 & P-04**  
Ramps which are too short will cause the drive to deliver currents in excess of full load current and may result in it tripping out or the motor stalling

**Stop Mode P-05**  
Select method of stopping required when drive is disabled. Ramp to stop (P-05 = 0) decelerates the motor at the rate set by deceleration ramp time P-04. Freewheel/ Coast to stop (P-05=1) disables the drive output immediately, allowing the motor to decelerate naturally due to friction or under the control of a mechanical brake

**Torque/Speed Characteristic P-06**  
Certain loads such as fans and centrifugal pumps need very little torque at low speed. Set P-06=1 to reduce power loss at low speeds for this load type.

**Rated Current, Rated Frequency and Rated Speed P-08, P-09, P-10.**  
Parameters P-08 and P-09 should be set to correspond with the rated current and frequency shown on the motor rating plate. Parameter P-10 is optional. If this parameter is set to zero (default state), speed will be displayed in Hz; if speed indication is required in rpm, enter the motor rated speed (speed at full load) from the motor rating plate.

**Voltage Boost P-11**  
Any load which is 'sticky' to start will benefit from a voltage boost on starting. P-11 permits a boost of up to 25% of full motor voltage to be applied.  
NOTE: Use of this parameter increases motor heating at low speeds

**Terminal or Keypad Control P-12**  
Terminal control (P-12=0) is used when the drive needs to be controlled from some remote point, such as a control panel interface or machine system.  
Keypad control (P-12=1 or 2) is used for local, manual control and commissioning

**Extended Parameter Set P15 to P-40 and P-00**  
The Extended Parameter Set is intended for use by specialist drives engineers and technicians and will not generally be required for simple applications.

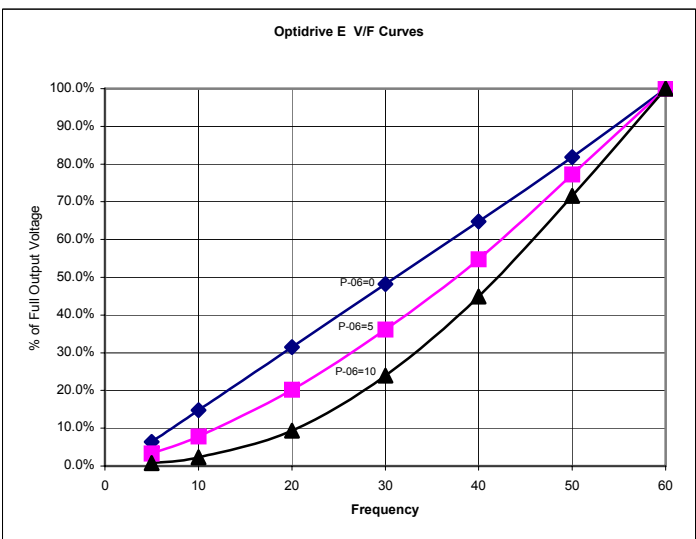

**Voltage / Frequency (V/f) Characteristic**

The V/f characteristic is defined by parameter P-06 as shown. Increasing the value of P-06 decreases the volts applied to the motor at a given frequency; reducing the voltage reduces the amount of current flowing in the motor hence the torque at the motor shaft. This feature is used to save energy in applications where the torque required at low speeds is less than at higher speeds. A particular value of P-06 should be determined by trial and error.

**Maximum supply ratings for UL compliance:**

Drive rating	Maximum supply voltage	Maximum supply short-circuit current
230V ratings - 0.37kW (0.5HP) to 2.2kW (3HP)	240V rms (AC)	5kA rms (AC)
400/460V/600V ratings - 0.75kW(1HP) to 4.0kW(5HP)	500V/600V rms (AC)	5kA rms (AC)

All the drives in the above table are suitable for use on a circuit capable of delivering not more than the above specified maximum short-circuit Amperes symmetrical with the specified maximum supply voltage.